

Diagram on following page

KENNEDY MIDDLE SCHOOL DANCE

DROP-OFF/PICK-UP PROCEDURES

6th Grade

Parents dropping-off/picking-up 6th grade students will enter from the south side driveway. (By Eichelberger Elementary School) You will drop off your student(s) along the sidewalk and they should proceed to the main entrance. After drop off, drivers will continue toward the back of the building to turn around and exit. When you pick up your student you will enter and exit in the same way you dropped off your student. If you are dropping-off/picking-up more than one student you should do so on the side of the student in the highest grade. (i.e. 6th grader and 8th grader together should be dropped off on the 7th & 8th grade side).

7th & 8th Grade

Parents dropping-off/picking-up 7th or 8th grade students will enter on the north side of the building. (Main entrance) As you enter the lot, you will proceed along the north driveway towards the back of the building and turn around to drop off your student in front of the building. (Main entrance) If you are dropping-off/picking-up more than one student you should do so on the side of the student in the highest grade. (i.e. 6th grader and 8th grader together should be dropped off on the 7th & 8th grade side).

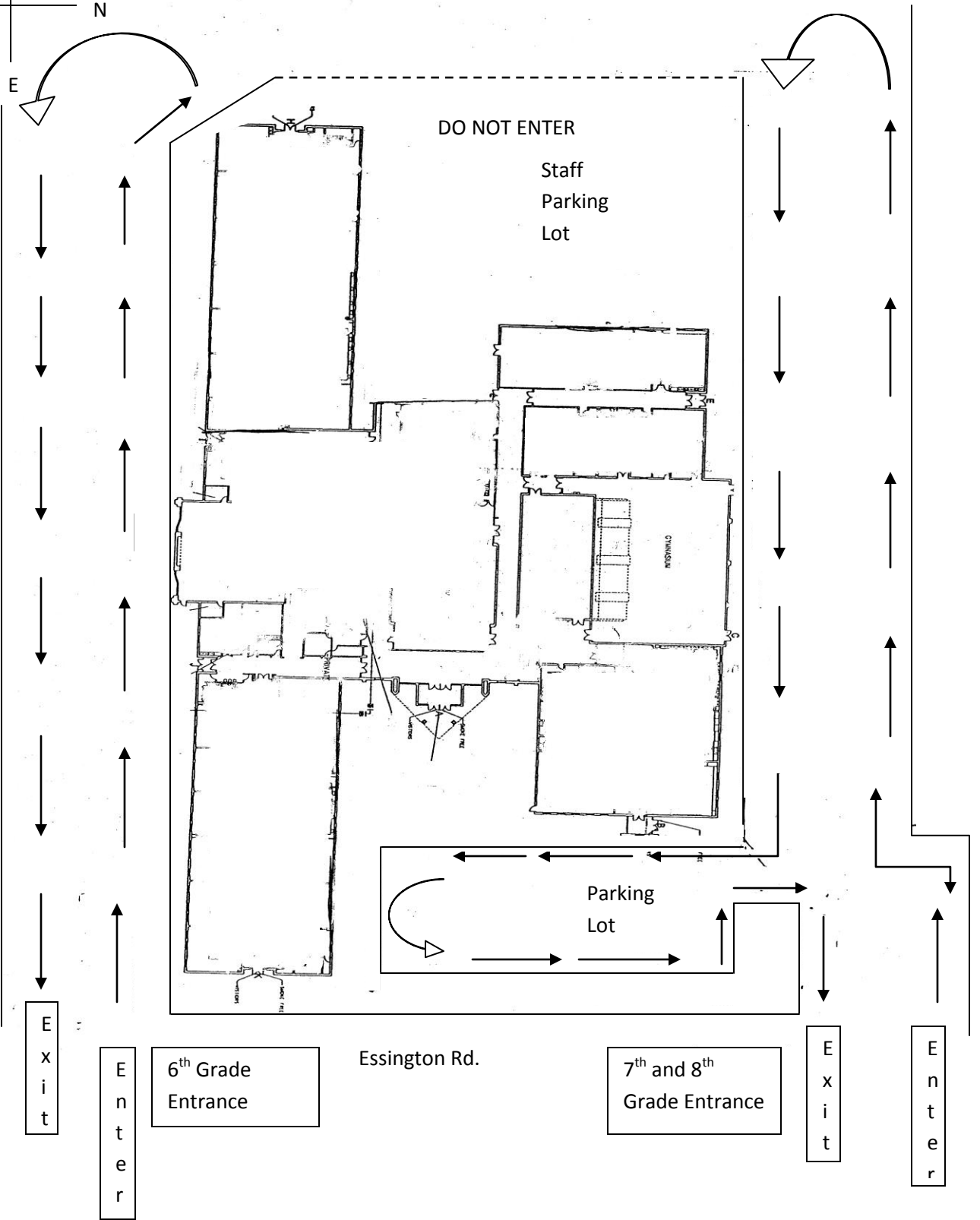
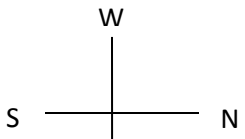

DO NOT ENTER

Staff
Parking
Lot

Parking
Lot

Essington Rd.

6th Grade
Entrance

7th and 8th
Grade Entrance

E
x
i
t

E
n
t
e
r

E
x
i
t

E
n
t
e
r