

District 202 Laptop Camera Information

If your child received a laptop from District 202, please be aware:

- Laptops take a while (maybe overnight) to charge and fully load all apps. Please charge your child's laptop prior to August 31st so he/she is ready to begin on time.
- Check your child's camera setting. Each laptop has a screen base camera and a keyboard base camera. Several cameras are defaulted to use the keyboard camera, but to participate in Zoom Meetings, it should be switched to the screen camera.

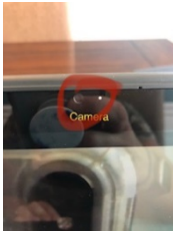

Screen camera

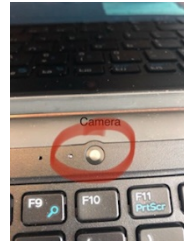

Keyboard Camera

- Log onto Zoom on the student laptop using the student login information
- Click on the profile picture and click "settings"
- Click the "video" tab
- This will show you a preview of your current active camera; if you need to switch the camera, select from the "camera" drop down menu

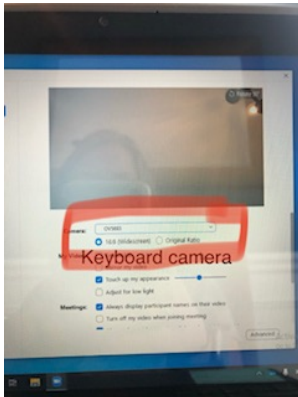

When making changes to the camera, you cannot be in a call; all changes should be completed prior to the actual Zoom call.